

Brass Ball Valve - Locking Lever

Nickel Plated Brass Body, Brass Ball & Stem, PTFE Seats, Full Bore

LV2312 - Yellow Lever Screwed BSPT

LV2318 - Red Lever Screwed BSPT

LV2314 - Red Lever Screwed NPT

Pressure / Temperature Specifications	
Pressure	PN40 ¼" to 1"
	PN25 1¼" to 2"
	PN16 2½" to 4"
Temperature	-20°C to 110°C

Material List	
Description	Material
Body	Brass
Bonnet	Brass
Ball	Brass
Stem	Brass
Seat	PTFE
Handle	Iron
Nut	Brass
O-Ring	NBR

Dimensions						
DN	Size	I	L	H	R	Kg
10	¼"	14	52	45	97	0.18
12	⅜"	16.5	52	48	96	0.17
15	½"	16	59	51	95	0.16
20	¾"	16	62	54	95	0.27
25	1"	18	71	66	111	0.41
32	1¼"	19	83	69	133	0.62
40	1½"	24	101	78	130	0.87
50	2"	20	104	99	200	1.5
65	2½"	33	152	125	245	2.03
80	3"	36	170	135	245	3.72
100	4"	41	205	145	245	5.98

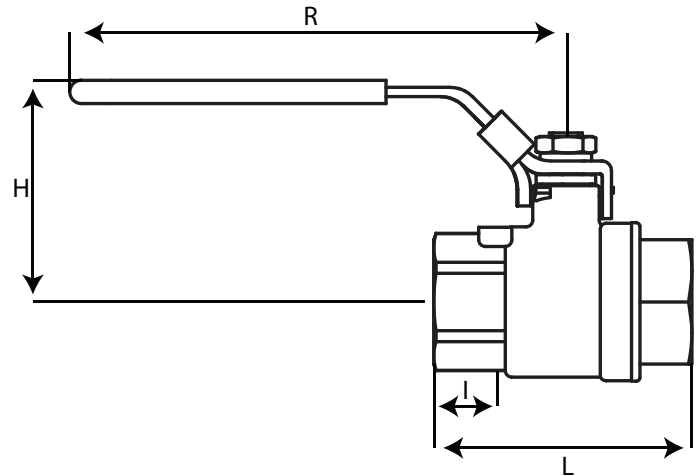

LV 2312 BSPT, LV2318 BSPT & LV 2314 NPT